

6176 MOUNTING STUD  
(SUPPLIED)

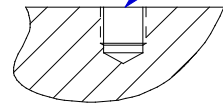
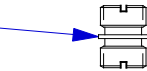

**MOUNTING PREPARATION**

PREPARE FLAT SURFACE (TO .001 TIR)  
NEXT DRILL #3 (.213) DIA X .250 DEEP  
BOTTOM TAP 1/4-28 UNF-2B X .200 MIN THREAD DEPTH

2. MOUNTING TORQUE - 20-25 LB.-IN.
1. WEIGHT - 130 GRAMS.

<b>DYTRAN</b> INSTRUMENTS, INC.		CHATSWORTH, CA.		
SCALE	1X	REV	DATE	ECN
DATE	1/7/94	PART NO.		
DRAWN	N.C.	CHECKED	MAT'L	
APPROVED	N.C.	NEXT ASSEMBLY		USED ON
TITLE				DWG NO.
<b>OUTLINE/INSTALLATION DRAWING, MODEL 3174C</b>				<b>127-3174C</b>
				SHEET 1 OF 1

## SPECIFICATIONS, MODEL 3174C CHARGE MODE ACCELEROMETER



SPECIFICATION	VALUE	UNITS
<b>PHYSICAL</b>		
WEIGHT	130	GRAMS
SIZE (HEX x HEIGHT) MODEL	.875 x 1.49	INCHES
MOUNTING PROVISION	1/4-28, UNF-2B TAPPED HOLE AT BOTTOM	
CONNECTOR, COAXIAL, RADIALLY MOUNTED	BNC JACK, HERMETIC	
CASE /CONNECTOR MATERIAL	STAINLESS STEEL, 300 SERIES	
<b>PERFORMANCE</b>		
SENSITIVITY, +/- 10%	10.0	pC/G
RANGE F.S.	500	G's
FREQUENCY RESPONSE, +/- 10% [1]	to 5000	Hz
MOUNTED RESONANT FREQUENCY, NOM.	25	kHz
AMPLITUDE NON-LINEARITY (ZERO BASED BEST FIT ST.LINE METHOD)	2.0	% F.S., MAX.
TRANSVERSE SENSITIVITY, MAX.	5	PERCENT
STRAIN SENSITIVITY	.001	G's PER MICROSTRAIN @ 250/μ
<b>ENVIRONMENTAL</b>		
MAXIMUM VIBRATION	500	G's, RMS
MAXIMUM SHOCK	2000	G's, PEAK
TEMPERATURE RANGE	-65 TO +500	°F
THERMAL COEFFICIENT OF SENSITIVITY	SEE CHART	
SEAL	WELDED/CERAMIC TO METAL	HERMETIC

**NOTE [1]** LOW FREQUENCY RESPONSE DEPENDS UPON DISCHARGE TIME CONSTANT OF CHARGE AMPLIFIER

### ELECTRICAL

CAPACITANCE	200	pF
OUTPUT SIGNAL POLARITY FOR ACCELERATION TOWARD TOP	NEGATIVE GOING	

**SUPPLIED ACCESSORY:** (1) MODEL 6176 STAINLESS STEEL COLLARED MOUNTING STUD, 1/4-28 threads.

**OPTIONAL ACCESSORY:** MODEL 6185 IMMERSION PROOF BOOT

