

| REV | ECN  | DESCRIPTION         | BY/DATE      | CHK | APPR |
|-----|------|---------------------|--------------|-----|------|
| C   | 5304 | EXTENSIVELY REVISED | RLA 8/28/08  | DV  | ANS  |
| D   | 5817 | ADDED STRAIN RELIEF | RLA 03/05/09 | EP  | ANS  |
| E   | 5905 | ADDED NOTE 2        | RLA 04/01/09 | EP  | ANS  |
| F   | 6154 | SEE ECN             | RLA 08/06/09 | EP  | DV   |
| G   | 6246 | SEE ECN             | RLA 09/25/09 | EP  | DV   |

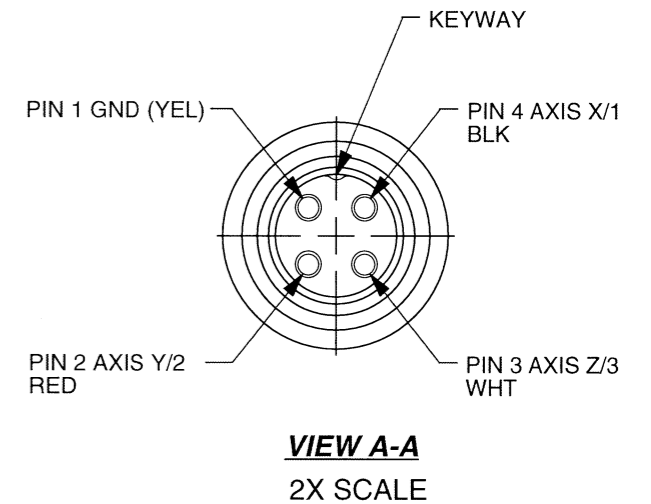
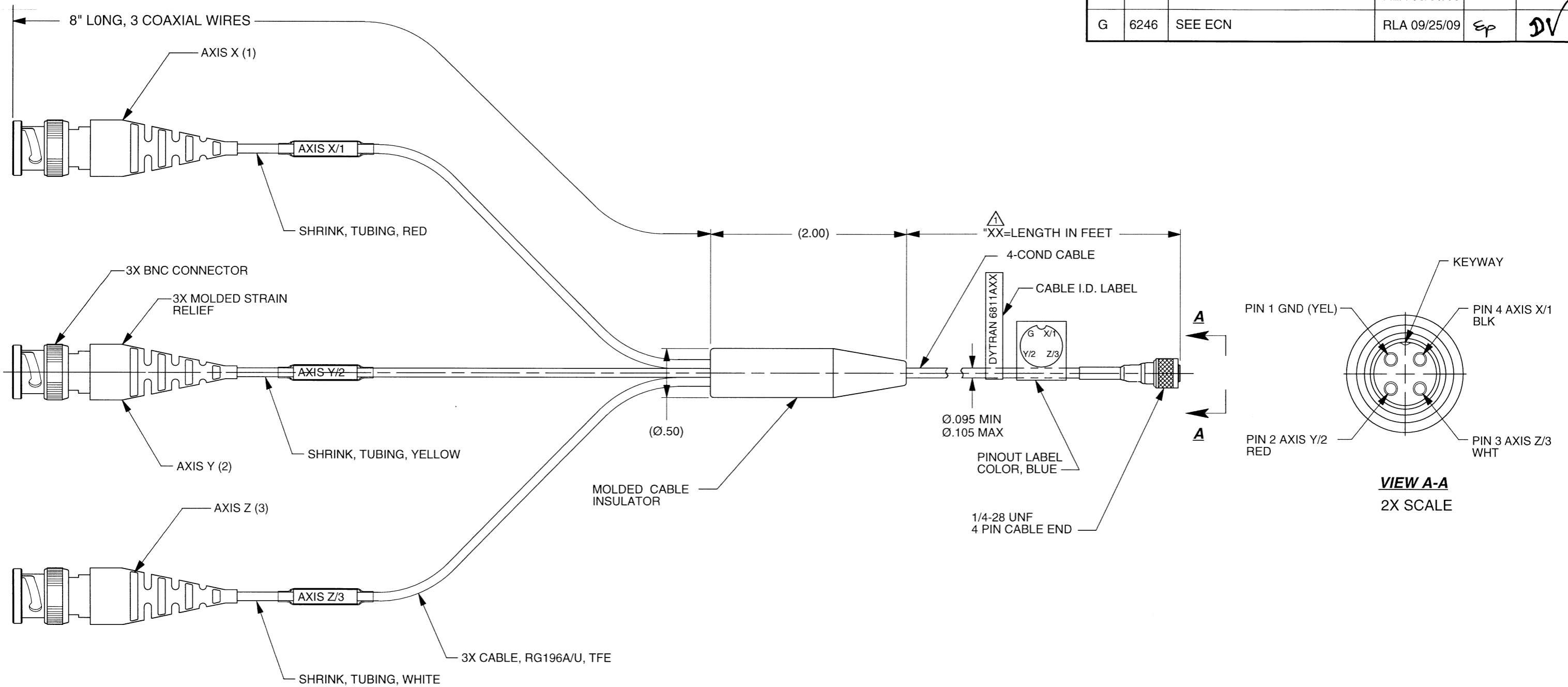

2. OPERATING RANGE: -67°F (-55°C) TO 230°F (110°C)

1 XX=WILL VARY IN FEET PER CUSTOMER REQUIREMENTS, FOR EXAMPLE: 6811A07 = 7 FT CABLE LENGTH

EXCEPT AS OTHERWISE NOTED  
 ALL DIMENSIONS IN INCHES  
 TOLERANCE: .XXX ± .xx ± .25  
 SURFACE FINISH EXCEPT AS NOTED ✓  
 BREAK EDGES TO DEBURR RADIUS OR CHAMFER  
 THESE DIAS TO T.I.R.  
 FILLETS - MAX RAD.

|                                                                                  |         |                              |               |                 |           |
|----------------------------------------------------------------------------------|---------|------------------------------|---------------|-----------------|-----------|
|                                                                                  |         | <b>MASTER ONLY IF IN RED</b> |               | CHATSWORTH, CA. |           |
| SCALE                                                                            | 1X      | REV                          | DATE          | ECN             |           |
| DATE                                                                             | 5/21/02 | PART NO.                     | MODEL 6811AXX |                 |           |
| DRAWN                                                                            | R.A.    | CHECKED                      | N.C.          | MAT'L           |           |
| APPROVED                                                                         | CES     | 12/20/06                     | NEXT ASSEMBLY | USED ON         |           |
| <b>OUTLINE/INSTALLATION DRAWING, CABLE ASSEMBLY, MINI 4 PIN, PLUG TO (3) BNC</b> |         |                              |               | DWG NO.         | 127-6811A |
|                                                                                  |         |                              |               | SHEET           | 1 OF 1    |