

CONNECTOR MATES WITH
DYTRAN CABLE 6430AXX

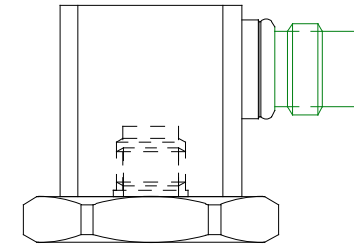

ALTERNATIVE MOUNTING
METHOD USING ADHESIVE
MOUNTING BASE MODEL 6213.

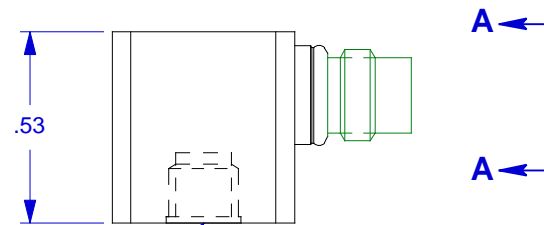

MOUNTING SURFACE
10-32 MOUNTING
HOLE X .150 DEEP

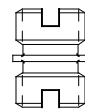

MODEL 6200 MOUNTING STUD,
PROVIDED

10-32 THREAD, TYP (REF)

SELECT SURFACE FLAT TO .001 TIR
MOUNTING HOLE PREPARATION
DRILL #21 (.159) DIA. X .250 DEEP
BOTTOM TAP 10-32 UNF-2B X .200
MIN. DEPTH PERF. THD.

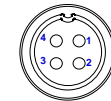
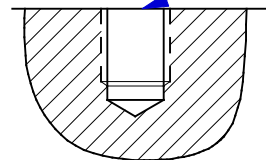

VIEW A-A LOOKING
INTO CONNECTOR

PINOUT
PIN #1 SIG/PWR AXIS 1 (X)
PIN #2 SIG/PWR AXIS 2 (Y)
PIN #3 SIG/PWR AXIS 3 (Z)
PIN #4 GND RETURN,
COMMON

- 4 WEIGHT: 7.5 GRAMS.
- 3 XX=LENGTH IN FEET.
- 2. + SIGNS INDICATE SENSE AND DIRECTION OF ACCELERATION FOR POSITIVE OUTPUT.
- 1. HOUSING MATERIAL: TITANIUM ALLOY

EXCEPT AS OTHERWISE NOTED	
ALL DIMENSIONS IN INCHES TOLERANCE: .XXX = ± .005 .XX = ± .01	
SURFACE FINISH EXCEPT AS NOTED	✓
BREAK EDGES TO DEBURR RADIUS OR CHAMFER	
△ THESE DIAS ⊙ TO	T.I.R.
FILLETS -	MAX RAD.

		CHATSORTH, CA.			
		SCALE 2X	REV -	DATE -	ECN -
DATE 8/7/00	PART NO. MODEL 3053B2				
DRAWN N.C.	CHECKED R.A.	MAT'L			
APPROVED	NEXT ASSEMBLY		USED ON	3053B2	
TITLE OUTLINE/INSTALLATION DRAWING, MODEL 3053B2			DWG NO. 127-3053B2		
SHEET 1 OF 1					



SPECIFICATIONS, MODEL 3053B2 TRIAXIAL ACCELEROMETER

SPECIFICATIONS	VALUE	UNITS
PHYSICAL		
WEIGHT	7.5	GRAMS
SIZE (HEIGHT x WIDTH x DEPTH)	0.53 x .50 x .50	INCHES
MOUNTING [1]	10-32 TAPPED HOLE IN BASE	
CONNECTOR	4-PIN [2]	
MATERIAL, HOUSING/CONNECTOR	TITANIUM ALLOY	
PERFORMANCE		
SENSITIVITY, -10% / +15% [3]	10.0	mV/G
RANGE, F.S. (each axis)	+/- 500	G
FREQUENCY RESPONSE, +/- 10%	2 to 5000	Hz
ELEMENT NATURAL FREQUENCY	>30	kHz
EQUIVALENT ELECTRICAL NOISE	.007	G, RMS
LINEARITY [4]	1	%F.S.
TRANSVERSE SENSITIVITY, MAX,	5	%
SIGNAL POLARITY	POSITIVE FOR MOTION IN DIRECTION OF ARROWS ON HOUSING	
ENVIRONMENTAL		
MAXIMUM VIBRATION	+/- 600	G
MAXIMUM SHOCK	5000	G
TEMPERATURE RANGE	-60 to +250	°F
ENVIRONMENTAL SEAL	HERMETIC	
COEFFICIENT OF THERMAL SENSITIVITY	.03	%/°F
ENVIRONMENTAL		
SUPPLY CURRENT RANGE, (each axis) [5]	2-to 20	mA
COMPLIANCE (SUPPLY) VOLTAGE RANGE (each axis)	+18 to +30	VDC
OUTPUT IMPEDANCE, TYP.	100	OHMS
OUTPUT BIAS VOLTAGE	+7 to +9	VDC
DISCHARGE TIME CONSTANT	0.5 to 1.0	SEC
GROUND ISOLATION	10	MEGOHMS (MIN)

[1] Case ground isolation is achieved by internal means.

[2] Connector mates with Dytran cable assy. Model 6041Axx. (xx = length in feet)

[3] Reference sensitivity measured at 100 Hz, 1 G RMS per ISA RP 37.2

[4] Linearity is % of specified full scale (or any lesser full scale range), zero-based best fit straight line method.

[5] Power only with Dytran LIVM power unit or other Dytran-compatible constant current type power unit. If power is applied without current limiting protection, the internal amplifier will be immediately destroyed.